

Recommended
P.C. Board SMD Layout

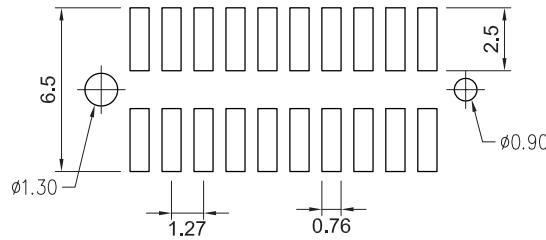

Specifications

- Current Rating: 1A
- Insulation Resistance: 1000M ohms / min
- Contact Resistance: 20m ohms max.
- Withstand Voltage: 300V AC
- Temperature Range: -40°C ~ +125°C
- Contact Material: Brass
- Insulator Material: Polyester, UL94V-0 Nylon-9T
- Contact Plated: See options
- Standard: Full Gold Flash

Part Numbering System

BH7C-SD-545655 - XX - X X X X N

- Series** _____
- No. of Pins** _____
- Body Option:** _____
 - A = with Post & with Polarization Bump
 - B = with Post & without Polarization Bump
 - C = without Post & with Polarization Bump
 - D = without Post & without Polarization Bump
- Contact Plating** _____
- Cap Option:** _____
 - Nil = No Cap
 - P = Plastic Cap
- Packing Method:** _____
 - B = Tube
 - T = Tape & Reel
- Insulator Material:** _____
 - N = High Temperature Nylon-9T

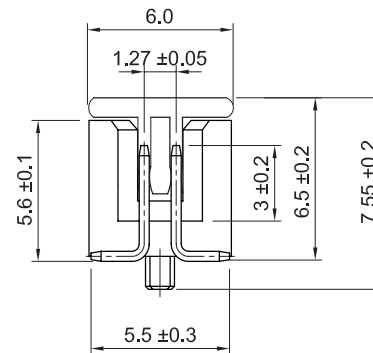
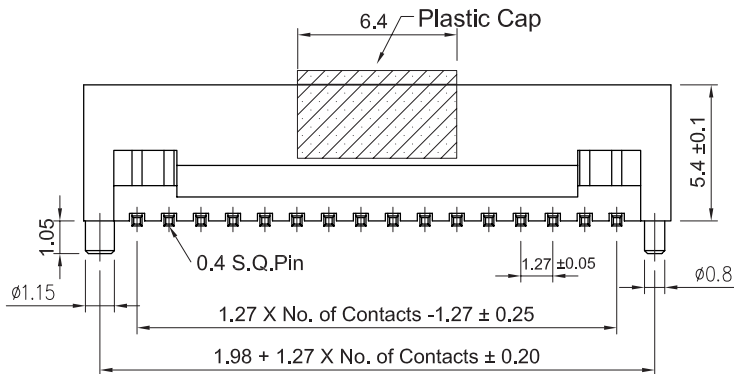

* Contact Plating Option	Full Gold Plating	Gold Plated on Contact Area Tin Plated on Solder Area	Full Tin Plating
	G : Gold Flash G10: Gold 10u" G15: Gold 15u" G30: Gold 30u"	S: Gold Flash S10: Gold 10u" S15: Gold 15u" S30: Gold 30u"	T: Tin 100u"

General Tolerance	
X. ± 0.50	X.° ± 5°
.X ± 0.20	.X° ± 2°
.XX ± 0.10	.XX° ± 1°
Units : mm	